

24513

24513

B. Tech 7th Semester Civil F-Scheme Examination,

December-2017

ESTIMATING AND COSTING

Paper-CE-405-F

Time allowed : 3 hours] [Maximum marks : 100

Note : Attempt five questions in all. All questions carry equal marks.

1. Explain
- (a) Principle of Estimation
 - (b) Sinking fund
 - (c) Type of estimate
 - (d) Earnest money
 - (e) Tender
 - (f) Actual cost
 - (g) Difference between scrap and salvage value
 - (h) Revised and supplementary estimate. 20

Section-A

2. What do you mean by estimate ? Also explain the different method of estimate in detail. 20
3. Find the quantity of earthwork, lime concrete in foundation and brickwork in super structure of Single

24513-P-3-Q-9 (17)

[P.T.O.

(2)

24513

room with verandah as per plan and elevation given below. And door size 1.2 m x 2.0m 20

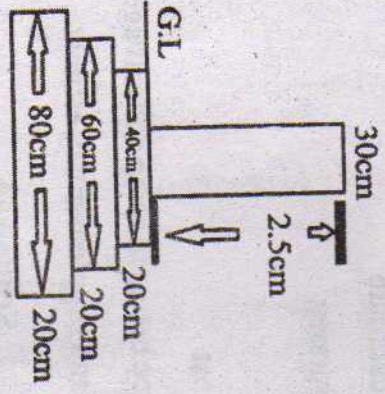
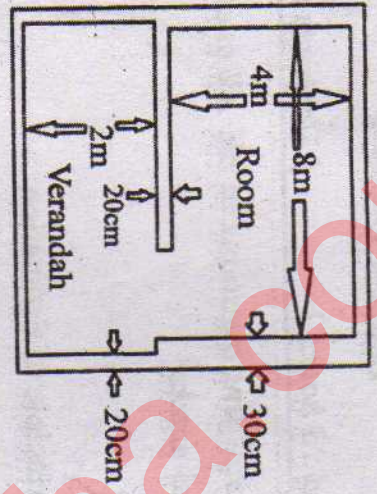

Section-B

4. Write the specification for the following item

- (a) Plaster
- (b) RCC

20

24513

(3)

24513

5. Explain the specification for different class of building. 20

Section-C

6. Find the rate analysis for 100 cu.m brickwork with mortar of ratio 1:6. 20

7. What is rate analysis ? Also explain its importance in construction work. Find the rate analysis for 100sq m of white washing. 20

Section-D

8. (a) Explain the need of muster roll. Also explain the rule to prepare muster roll. 20

(b) What is procedure to maintain measurement book ? 20

9. (a) What is depreciation ? Explain different method of depreciation. 20

(b) What do you mean by Tender and its acceptance ? 20

24513